

Amplified: 11/08/2021 REV 3

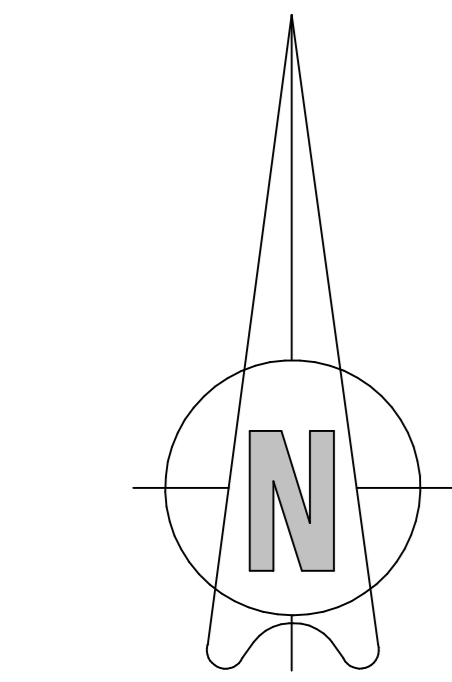

SEE 11159 5001-1

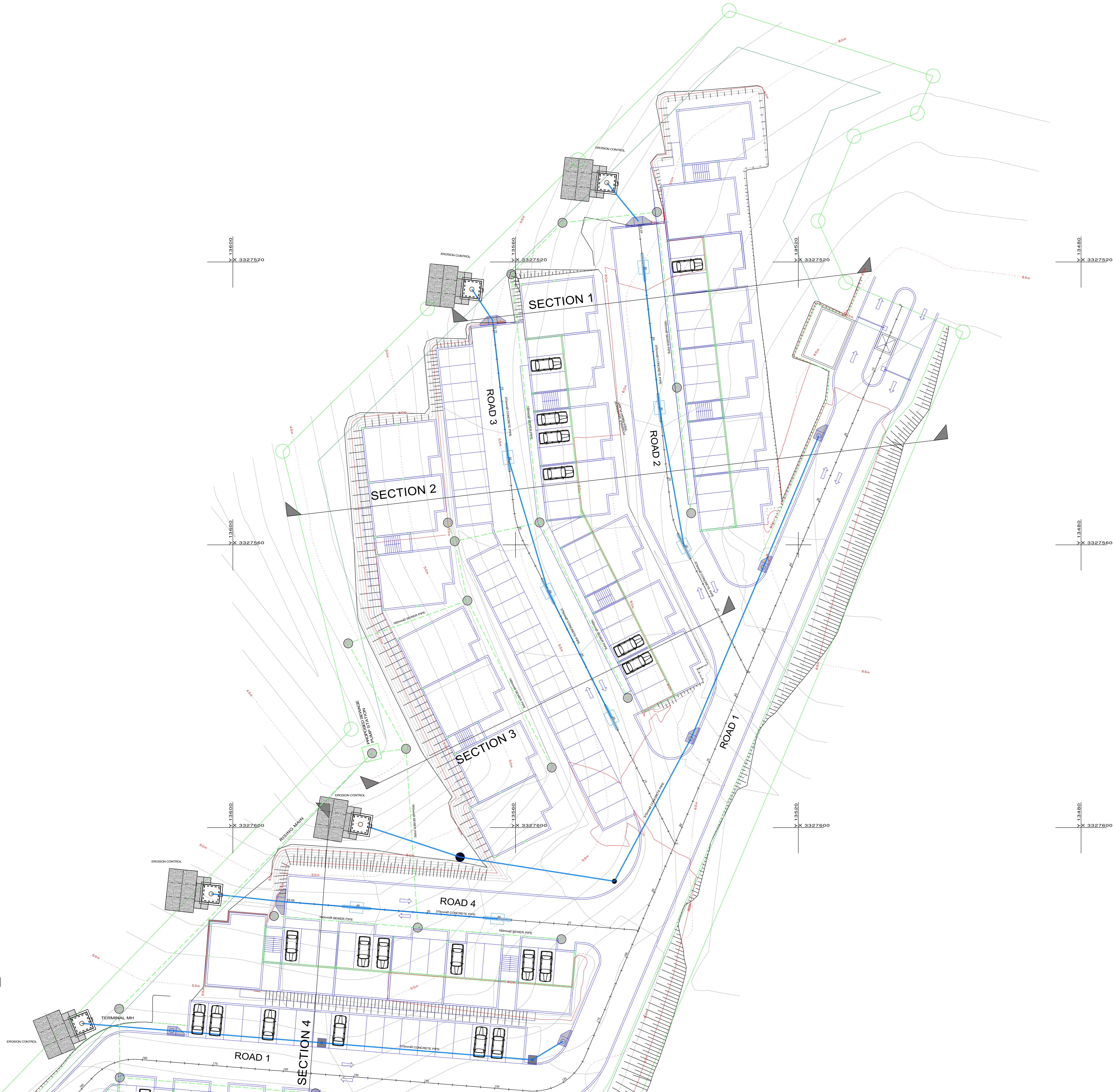

"COPYRIGHT IS VESTED IN SIVEST IN TERMS OF THE COPYRIGHT ACT (ACT 98 OF 1978) AND NO USE OR REPRODUCTION OR DUPLICATION THEREOF MAY OCCUR WITHOUT THE WRITTEN CONSENT OF THE AUTHOR"

THIS DRAWING HAS BEEN PREPARED UNDER THE CONTROLS ESTABLISHED BY THE SIVEST QUALITY MANAGEMENT SYSTEM, WHICH HAS BEEN CERTIFIED ISO 9001:2008 COMPLIANT

- GENERAL NOTES
1. THIS DRAWING PROVIDES INFORMATION RELATED TO THE FORM OF THE WORK WHEN COMPLETED TOGETHER WITH GUIDANCE, WHERE FUNDAMENTAL TO THE DESIGN, FOR THE SEQUENCE OF CONSTRUCTION. THIS DRAWING DOES NOT PURPORT TO INCLUDE ANY NECESSARY PRECAUTIONS, ITEMS OR COMPONENTS REQUIRED FOR CONSTRUCTION SAFETY. ALL SUCH PRECAUTIONS MUST BE TAKEN AND ITEMS OR COMPONENTS SUPPLIED BY THE CONTRACTOR.
 2. ANY DISCREPANCIES ARE TO BE CONFIRMED WITH THE ENGINEER ON SITE PRIOR TO WORKS PROCEEDING.
 3. ONLY WRITTEN DIMENSIONS SHALL BE USED.
 4. ALL DIMENSIONS ARE IN METERS
 5. ALL EXISTING SERVICES TO BE PROVEN BY CONTRACTOR ON SITE PRIOR TO WORKS PROCEEDING.
 6. ALL WORK TO BE CARRIED OUT IN ACCORDANCE WITH THE SANS 1200 SERIES SPECIFICATION.

- NOTES:
1. SERVICES INDICATIVE, SUBJECT TO FINAL DESIGN.
 2. SEWAGE PACKAGE PLANTS TO BE POSITIONED AND CONFIGURED BY SPECIALIST ENGINEER.

- 30m BUFFER
160mm SEWER
375mm STORMWATER

SURVEY DATA PROVIDED BY

REFERENCE DRAWINGS

DETAIL STP LAYOUTS SHOWN	AS	01/08/23	3
STW OUTLET STRUCTURES UPDATED	AS	23/02/23	2
ADDITIONAL STW PIPES AND BUFFER ADDED	AS	11/01/23	1
FOR APPROVAL	AS	29/11/21	0
SEWAGE PACKAGE PLANT ADDED	AS	21/10/21	B
FOR DISCUSSION	AS	31/08/21	A

Revision Details

DURBAN OFFICE
4 PEARCEWAY CRESCENT
LA LUCIA RIDGE OFFICE ESTATE
UMHANGA ROAD 4202
SOUTH AFRICA
Tel: +2731 5811500
Fax: +2731 5862371
email: info@sivest.co.za



Client

DANS SPARES CC

Project Title

PROPOSED DEVELOPMENT
KINGSBURGH EXT 9

Drawing Title

PROPOSED LAYOUT
OF ERF 2954

Scale on A0
1:200

Size at full scale plot
0 10 20 30 40 50m

PREPARED BY: A.SERFONTEIN	DATE: 31.08.2021
CHECKED BY: G.VISSER	Pr No: 960720
SIGNATURE:	DATE: 01.08.2023
APPROVED BY: G.VISSER	Pr No: 960720
SIGNATURE:	DATE: 01.08.2023

SIVEST Drawing Number: 11159/5000-1

Revision: 3

FOR APPROVAL